

## CT30P-30T330-1

Former P/N: CEPT300A165-530-33P15R

Rev. 1-2019  
RoHS3 & REACH  
Piezoelectric Sound Transducers

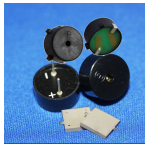

### Operating Characteristics

#### ELECTRICAL

Rated Voltage	12 Vp-p
Max Operating Voltage	30 Vp-p
Max Current at V Rated	10 mA
Capacitance	25,000 pF ± 30 % 120 Hz

#### ACOUSTIC

Min SPL at V Rated	90 dB
Test Conditions	10 cm
$f_o$	3300 ± 500 Hz

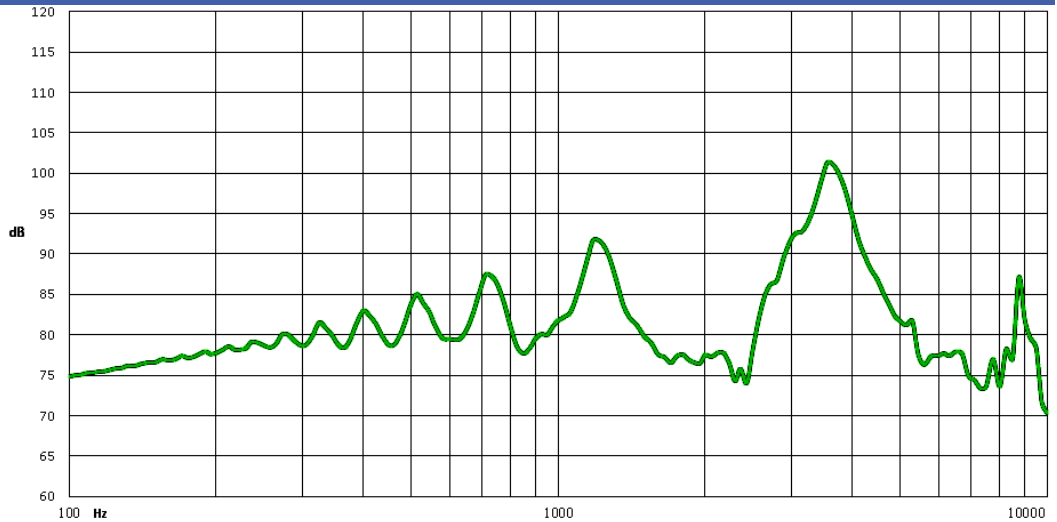

### Physical Characteristics

#### MATERIALS

Housing	Noryl Black
Diaphragm	Brass
PC Pin	Red Copper

#### TEMPERATURE RANGES

Operating	-30 to +70 °C
Storage	-40 to +85 °C

Weight 7 g

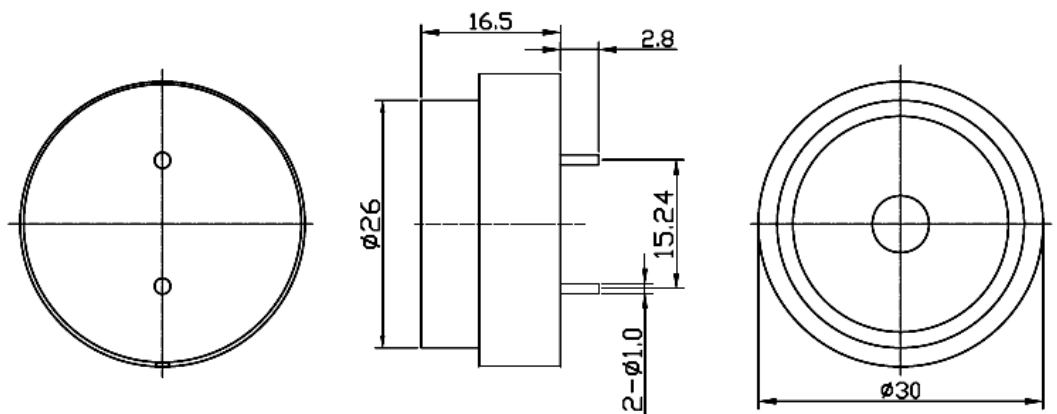

Revision	Description	By	Date
1-2019	Migrate to new format	WS	2019-06-21

Warranty: For a period of one (1) year from date of shipping under normal operations conditions This warranty does not apply to products damaged through misuse, abuse, improper installation, alteration, rework, or attempt to repair.