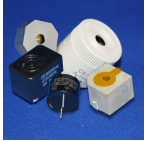

CI36P-15E290-C-5X

Former P/N: CE-CX215AS

Rev. 6-2026
RoHS3 & REACH
300 HR ASTM B117 & IP68
Piezoelectric Indicators

Operating Characteristics

ELECTRICAL

Rated Voltage	12 VDC
Operating Voltage	2 to 15 VDC
Max Current at Vmax	40 mA

ACOUSTIC

Tone Category	Continuous
Description	Steady
Center f	2,900 \pm 500 Hz
Min SPL at Vmin	70 dB
Min SPL at Vmax	98 dB
SPL Test Conditions	61 cm

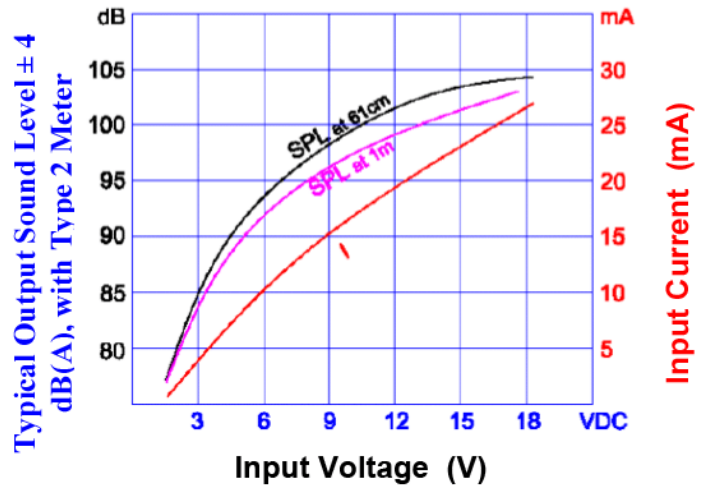

Physical Characteristics

MATERIALS

Housing	Noryl PX9406
Diaphragm	Stainless Steel
Terminal	Electro-Tin Plated Brass

TEMPERATURE RANGES

Operating	-30 to +65 °C
Storage	-40 to +100 °C

Weight 37 g

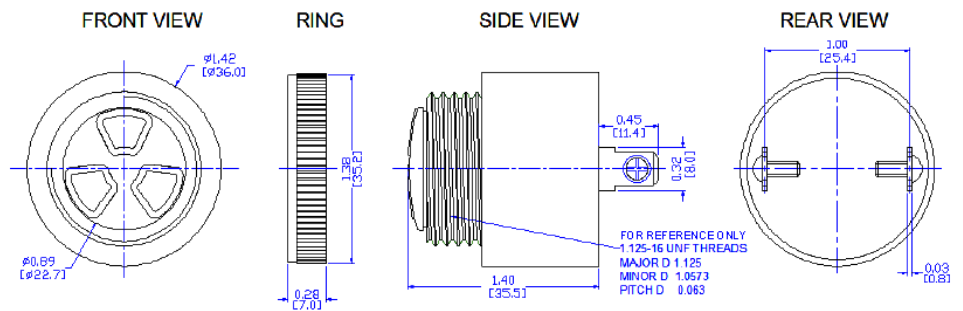
General tolerance = ± 0.7 mm and all measurements in mm unless otherwise noted.

Revision	Description	By	Date
5-2013	Revised Operating Temperature	EZ	2013-06-25
6-2026	Migrate to new format. Updated the Max Current at Vmax from 30mA to 40mA. Updated the Min SPL at Vmax from 100dB to 98dB. Updated the Operating Temperature from -30 to +85 °C to -30 to +65 °C. Updated the storage Temperature from -40°C to +105°C to -40°C to +100°C. Updated mechanical drawing.	KG	2026-01-07

Warranty: For a period of two (2) years from date of shipping under normal operations conditions. This warranty does not apply to products damaged through misuse, abuse, improper installation, alteration, rework, or attempt to repair. IP Rating ensures functionality after water has been drained fully from device.

The information contained herein is believed to be correct, but no guarantee or warranty, express or implied, with respect to accuracy, completeness or results is extended and no liability is assumed. Challenge Electronics reserves the right to make changes in any specification, data or material contained herein.