

INDICATORS • SPEAKERS • SOUND TRANSDUCERS • ENCLOSURES • MICROPHONES • BATTERY ACCESSORIES

CI26M-16T40-C-1

Former P/N: CEMB26K197-12C04PR / CEMB26K-12

Rev. 5-2021
RoHS3 & REACH
Mechanical Indicators



Operating Characteristics

ELECTRICAL

Rated Voltage	12 VDC
Operating Voltage	8 to 16 VDC
Max Current at Vmax	45 mA

ACOUSTIC

Tone Category	Continuous
Description	Steady
Center f	400 ± 100 Hz
Min SPL at Vrated	95 dB
Test Conditions	10 cm

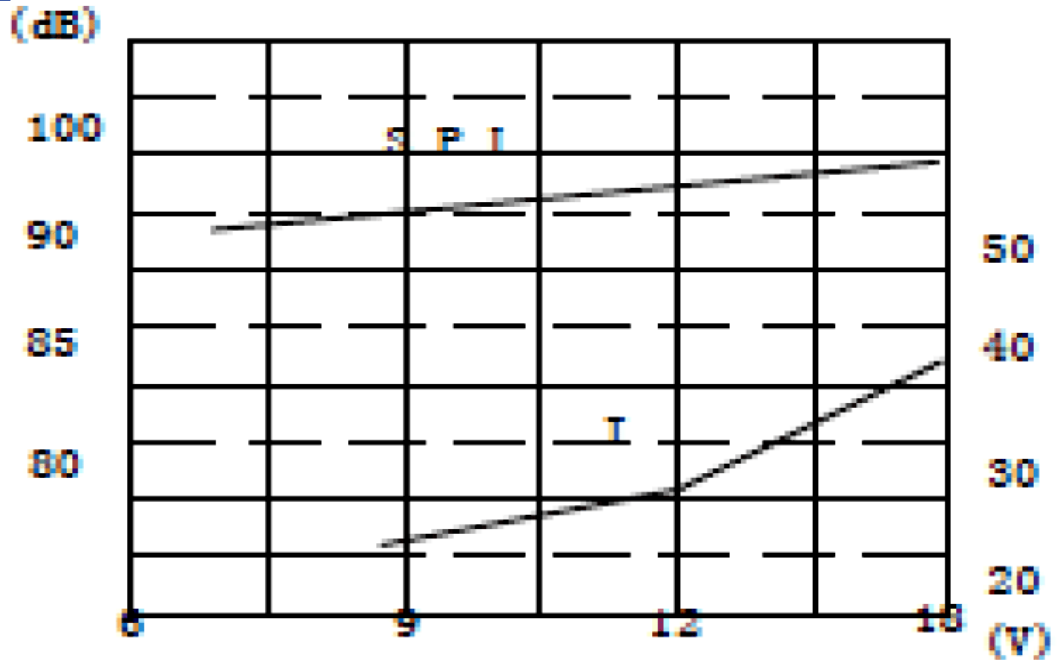

Physical Characteristics

MATERIALS

Housing	ABS
Diaphragm	Stainless Steel
PC Pin	Copper/Brass

TEMPERATURE RANGES

Operating	-20 to +60 °C
Storage	-30 to +70 °C

Weight 17 g

Tolerance: ±0.5mm

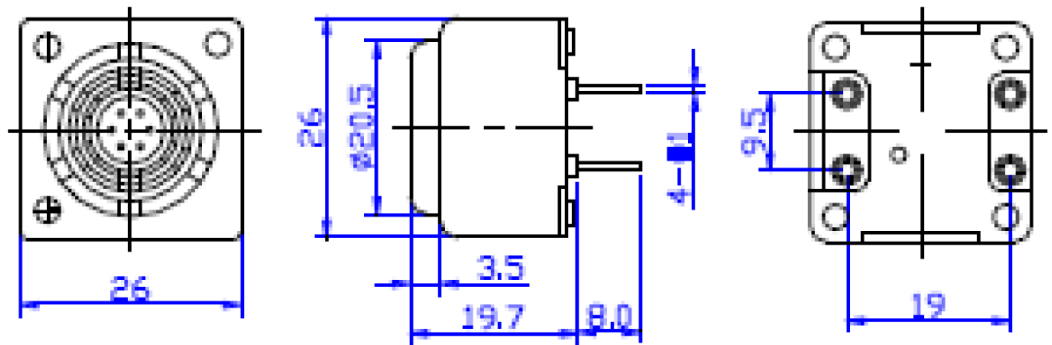

All Measurements are mm unless noted otherwise.

Revision	Description	By	Date
4-2020	Added abbreviated former PN. Added general tolerance.	JL	2020-11-05
5-2021	Updated max current at maximum voltage from 50 mA to 45 mA.		2021-02-12

Warranty: For a period of one (1) year from date of shipping under normal operations conditions This warranty does not apply to products damaged through misuse, abuse, improper installation, alteration, rework, or attempt to repair.

The information contained herein is believed to be correct, but no guarantee or warranty, express or implied, with respect to accuracy, completeness or results is extended and no liability is assumed. Challenge Electronics reserves the right to make changes in any specification, data or material contained herein.

©2021 Challenge Electronics, Inc. Pub. 20210212141030